

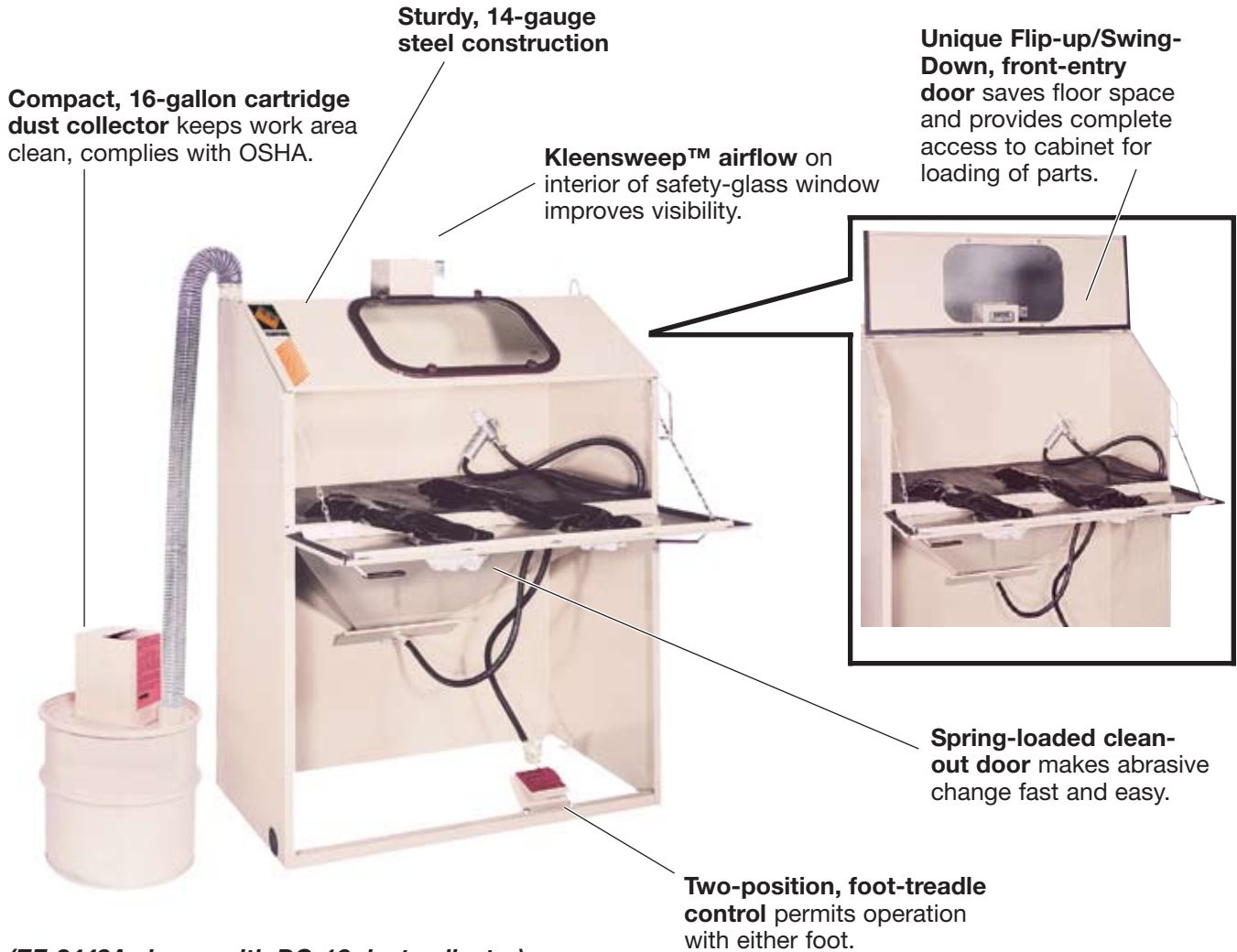

# Econo-Finish® Cabinets

**Excellent Value & Design  
At a Very Low Price**



**Compact, 16-gallon cartridge dust collector** keeps work area clean, complies with OSHA.

**Sturdy, 14-gauge steel construction**

**Kleensweep™ airflow** on interior of safety-glass window improves visibility.

**Unique Flip-up/Swing-Down, front-entry door** saves floor space and provides complete access to cabinet for loading of parts.

**Spring-loaded clean-out door** makes abrasive change fast and easy.

**Two-position, foot-treadle control** permits operation with either foot.

***(EF-2448A shown with DC-16 dust collector)***

Empire's inexpensive Econo-Finish® blast cabinets feature a unique front-access door to simplify loading of parts, save floor space and speed finishing operations.

Designed for light-to-medium cleaning and surface-finishing jobs, these economical cabinets combine sturdy, 14-gauge steel construction with the features you need to perform a wide range of finishing tasks. All Econo-Finish cabinets are equipped with a foot-treadle blast control for ease of operation, an external media-regulation device, quick-change safety glass and an improved dust-collection system.

In addition, you can select from upgraded features such as production-quality blast guns, a pressure regulator with gauge, long-life blast nozzles and a

high-capacity dust collector that extends operating intervals between clean-outs. The DC-16 and DC-30 dust collectors feature a cartridge filter with 16-gallon and 30-gallon dust capacities and built-in silencers.

Econo-Finish cabinets are available in two basic configurations: models with two-piece, swing-down and flip-up doors for maximum interior access (shown above) and an even more economical unit with a swing-down door only. Models with two-piece doors can be specified with a standard upgrade package designed to extend usage and maximize production.

To find out more about the best bargain in abrasive blast cabinets, call Empire or your Empire distributor and ask to see an Econo-Finish cabinet in action.



## FOR LIGHT-DUTY FINISHING

Empire's model EF-2430B blast cabinet provides an excellent opportunity for first-time blast-finishing users to appreciate the capabilities of abrasive blasting.

The basic design of this cabinet is the same as on other Econo-Finish models, but to further reduce costs, a single-piece, swing-down door is used in place of the standard two-piece door.



(EF-2430B Shown)

## AIR REQUIREMENTS (SCFM)

Operating Pressure	40 psi	60 psi	80 psi	100 psi
MH-4 (1/4" nozzle, 3/32" air jet)	7	10	12	15
MH-2A (1/4" nozzle, 1/8" air jet)	12	17	21	26

To determine the amount of SCFM your compressor can produce, use the following guideline: 1 horsepower = approximately 4 SCFM of air.

Different nozzles and air-jet sizes are available to broaden blast patterns, increase finishing rates or conserve compressed air. Consult your distributor and the air-requirement chart for appropriate nozzle and compressor sizes.

**Do not use silica sand in a hand cabinet.** Before ordering, consult your local Distributor for application considerations that may affect the performance of your system.

## OTHER EMPIRE PRODUCTS

- A full range of cabinets—economy to custom
- Basket blasters for batch processing
- Automated blast systems
- Pneumatic blast & recovery systems
- Plastic-media stripping systems
- Blast rooms
- Portable blasters
- Centrifugal-disc deburring systems

## SPECIFICATIONS BY MODEL NO. (Dimensions in inches)

Model Number	EF-2430B	EF-2436A EF-2436B	EF-2448A EF-2448B
Part Number	114013	115011 115013	116011 116013
Overall Dimensions (DxWxH)	24x30x65	24x36x65	24x48x65
Interior Dimensions (DxWxH)	24x30x23	24x36x23	24x48x23
Door Opening (WxH)	29x14	35x23	47x23
Door Type	Single	Two Piece	Two Piece
Weight (B Series)	215 lbs.	235 lbs.	275 lbs.
Weight (A Series)	—	285 lbs.	325 lbs.

## SPECIFICATIONS BY SERIES

	"B" Series (basic unit)	"A" Series (upgrade)
Cabinet Construction	Heavy, 14-Gauge Steel	
Floor Capacity	200 lbs.	
Gloves	Rubber, Cloth Lines, 8" dia.	
Blasting System	Suction, Foot Treadle	
Piping String	3/8"	
Nozzle Material	Ceramic	
Media Regulator	SAR-3	
Blast Gun	MH-4	MH-2A
Pressure Regulation/Gauge	Option	Standard
Window Safety Glass	14"x22" with Quick-Change Frame	
Lighting	90 W Floodlight	
Dust Collector	DC-16 (16 Gal.)	DC-30 (30 Gal.)
Filter Area	22 ft <sup>2</sup>	55 ft <sup>2</sup>
Collector Dimensions (Diameter x Height)	16"x22"	16"x39"
Fan Silencer/dBA	Standard/85	
Motor Fan	0.98 hp/133 CFM	
Electrical System	115V, 50-60 Hz, Single Phase	

(Options available for all models partial listing): OSHA Safety Door Switch, Safety Matting, Special Electricals, Pressure Regulator, Air Gauge, DiCarb and Boron Nozzles.

Information subject to change without notice.

Distributed By:

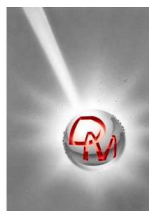

Dawson-Macdonald Co., Inc.  
 845 Woburn Street - Wilmington, MA 01887  
 Phone: (800) 556-4456 (toll free) Fax: (978) 657-8740  
 E-mail: info@dawson-macdonald.com  
 Website: www.dawson-macdonald.com

**EMPIRE**  
**ABRASIVE EQUIPMENT**  
 2101 West Cabot Boulevard, Langhorne, PA 19047-1893  
 CALL: (215) 752-8800 E-MAIL: Airblast@empire-airblast.com  
 FAX: (215) 752-9373 VISIT: www.empire-airblast.com